Appendix A

Pagemarq Printers

Table of Contents

Section 1	Spare Parts	
	Paper Feed and Registration	A-2
	Paper Transportation and Fusing	A-3
	Multipurpose Feeder	A-3
	Laser Assembly	A-3
	Transfer Corotron and Upper Unit	A-3
	Power Supplies and Engine Control	A-4
	Boards	A-4
	System Controller Options and Harness	A-5
	Paper Trays	A-5
	Covers	A-5
	Tools and Supplies	A-6
Section 2	Connector Locators	
	Connector Locators	A-7
Section 3	Before Calling for Help	
	Before Calling for Help	A-9

Pagemarq Printers

FREQUENTLY USED SPARE PARTS	
A. Paper Feed and Registration	
Part Number	Description
134538-001 DISCONTINUED	Registration Transport
134548-001 DISCONTINUED	Pre-Registration Sensor
134539-001 DISCONTINUED	Feed Roll (for Tray 1, 2, or 3)
134546-001 DISCONTINUED	Tray 1 No Paper Sensor
134547-001 DISCONTINUED	Tray 1 Paper Size Sensor
134545-001 DISCONTINUED	Tray 1 Feed Solenoid
134384-001 DISCONTINUED	Tray 2 Turn Roll Assembly
134390-001 DISCONTINUED	Tray 2 No Paper Sensor
134385-001 DISCONTINUED	Tray 2 Feed Solenoid
134389-001 DISCONTINUED	Tray 2 Paper Size Sensor
134392-001 DISCONTINUED	Tray 3 Turn Roll Assembly
134395-001 DISCONTINUED	Tray 3 No Paper Sensor
134393-001 DISCONTINUED	Tray 3 Feed Solenoid
134394-001 DISCONTINUED	Tray 3 Paper Size Sensor
134533-001 DISCONTINUED	Manual Tray Assembly

Continued

Pagemarq Printers

FREQUENTLY USED SPARE PARTS	
B. Paper Transportation and Fusing	
Part Number	Description
134577-001 DISCONTINUED	Fuser, 110-V, Model 15
134578-001 DISCONTINUED	Fuser, 110-V, Model 20
134579-001 DISCONTINUED	Fuser, 220-V, Model 15
126408-001 DISCONTINUED	Fuser, 220-V, Model 20
134576-001 DISCONTINUED	Fuser Cleaning Felt
126406-001	Fuser Sensor, Model 15
126407-001 DISCONTINUED	Fuser Sensor, Model 20
134580-001 DISCONTINUED	Heat Lamp, 110-V, Model 15
134581-001 DISCONTINUED	Heat Lamp, 110-V, Model 20
134582-001 DISCONTINUED	Heat Lamp, 220-V, Model 15
134583-001 DISCONTINUED	Heat Lamp, 220-V, Model 20
126353-001 DISCONTINUED	Output Tray Full Sensor
C. Multipurpose Feeder	
Part Number	Description
134396-001 DISCONTINUED	Multipurpose Feeder
D. Laser Assembly	
Part Number	Description
134590-001 DISCONTINUED	Laser Assembly (Model 15)
134591-001 DISCONTINUED	Laser Assembly (Model 20)
200080-002	Print Cartridge, Enhanced II
E. Transfer Corotron and Upper Unit	
134559-001 DISCONTINUED	Transfer Corotron
134557-001 DISCONTINUED	Toner Sensor
134558-001 DISCONTINUED	Print Cartridge Sensor

Continued

Pagemarq Printers

FREQUENTLY USED SPARE PARTS		
F. Power Supplies and Engine Control		
Part Number	Description	
134594-001 DISCONTINUED	Low Voltage Power Supply, 110-V	
134595-001 DISCONTINUED	Low Voltage Power Supply, 220-V	
134596-001 DISCONTINUED	High Voltage Power Supply, Model 15	
126410-001 DISCONTINUED	High Voltage Power Supply, Model 20	
134597-001 DISCONTINUED	Fuser Exhaust Fan	
134598-001 DISCONTINUED	Engine Controller Board, Model 15	
134599-001 DISCONTINUED	Engine Controller Board, Model 20	
G. Boards		
Part Number	Description	Assembly #
134455-001 DISCONTINUED	System Controller Board (15)	002370
134339-001 DISCONTINUED	System Controller Board (20)	002373
134217-001 DISCONTINUED	Ver 2 System Controller Board (15)	002410
134216-001 DISCONTINUED	Ver 2 System Controller Board (20)	002407
194566-001 DISCONTINUED	Ver 2 System Controller Board (15)	002410 (7.0 code)
194565-001 DISCONTINUED	Ver 2 System Controller Board (20)	002407 (7.0 code)
134456-001 DISCONTINUED	AppleTalk Board	002062
126403-001 DISCONTINUED	Token Ring Board	002334
126404-001 DISCONTINUED	Ethernet Board (UTP/AUI)	002328
126405-001 DISCONTINUED	Ethernet Board (BNC/AUI)	002331
126409-001 DISCONTINUED	Fax Modem (US & Canada only)	002475

Continued

Pagemarq Printers

FREQUENTLY USED SPARE PARTS			
H. System Controller Options and Harness			
Part Number	Description	Assembly #	Option #
Not Available	60 MB Hard Drive		
134214-001 DISCONTINUED	120 MB Hard Drive	135095-001	134446-002
134457-001 DISCONTINUED	Hard Drive Interface Board	002355	
142734-001 DISCONTINUED	Controller Blower		
134564-001 DISCONTINUED	1 MB Font Module		126357-001
134565-001 DISCONTINUED	2 MB Font Module		126358-001
140907-001 DISCONTINUED	1 MB Mem Module (80ns)		126359-001 (2 MB)
140908-001 DISCONTINUED	2 MB Mem Module (80ns)		126360-001 (4 MB)
140909-001 DISCONTINUED	4 MB Mem Module (80ns)		126361-001 (8 MB)
140910-001 DISCONTINUED	8 MB Mem Module (80ns)		126362-001 (16 MB)
I. Paper Trays			
Part Number	Description	Option #	
134532-001 DISCONTINUED	Paper Tray Cover		
126416-001	TwinTray, Letter (DISCONTINUED)	126453-001	
126415-001 DISCONTINUED	TwinTray, A4 (DISCONTINUED)	126454-001	
134540-001 DISCONTINUED	Paper Tray, Ledger	126439-001	
134542-001 DISCONTINUED	Paper Tray, Legal	126438-001	
134541-001 DISCONTINUED	Paper Tray, A3	126440-001	
134543-001 DISCONTINUED	Paper Tray, A5 (Long Edge Feed)	126441-001	
134544-001 DISCONTINUED	Paper Tray, B4	126442-001	
142732-001 DISCONTINUED	Paper Tray, Letter (Long Edge Feed)	140924-001	
142733-001	Paper Tray A4 (Long Edge Feed)	140925-001	
J. Covers			
Part Number	Description		
134573-001 DISCONTINUED	Exit Door		
126411-001 DISCONTINUED	Top Cover		
134568-001 DISCONTINUED	Rear Cover		
134211-001 DISCONTINUED	Actuator Guide		

Continued

Pagemarq Printers

FREQUENTLY USED SPARE PARTS	
K. Tools and Supplies	
Part Number	Description
140913-001	Printer Diagnostic Tool (Kit)
143031-001 DISCONTINUED	Serial Loopback Tool
140968-001 DISCONTINUED	Interlock Bypass Tool
140970-001 DISCONTINUED	Feed Roll Cleaner
140993-001 DISCONTINUED	Cleaning Kit (4 in 1)
140971-001 DISCONTINUED	Print Quality Pattern
143032-001 DISCONTINUED	Repack Kit

Pagemarq Printers

CONNECTOR LOCATORS

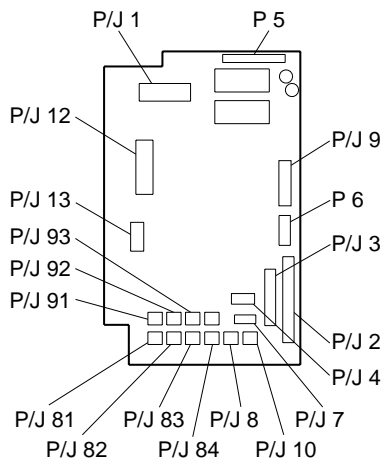

ENGINE CONTROLLER BOARD

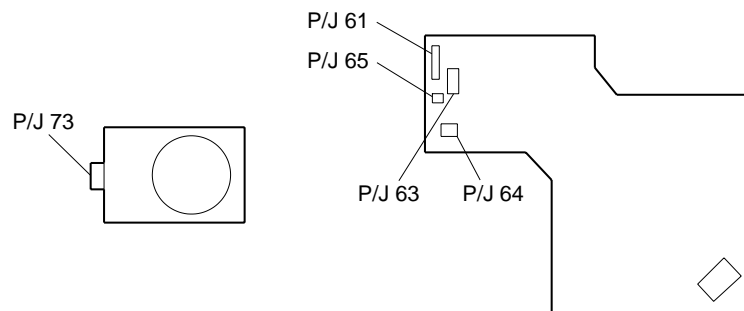

MAIN DRIVE MOTOR

LOW VOLTAGE
POWER SUPPLY

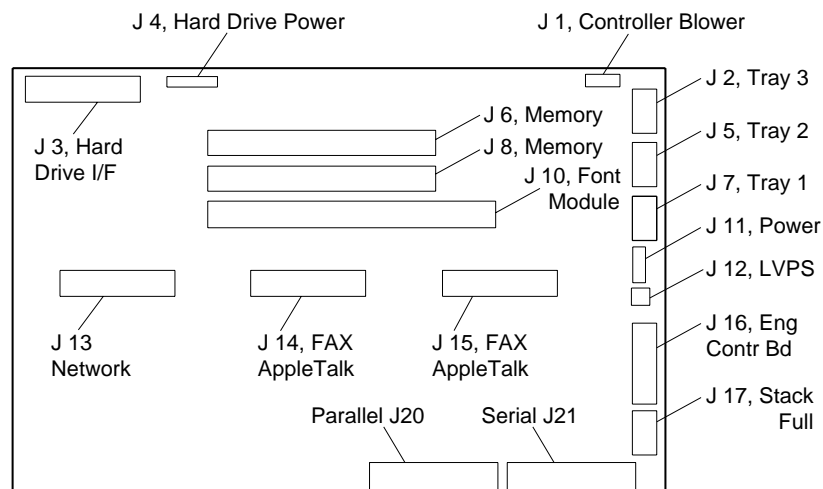

SYSTEM CONTROLLER BOARD

PHYSICAL CONNECTOR LOCATIONS

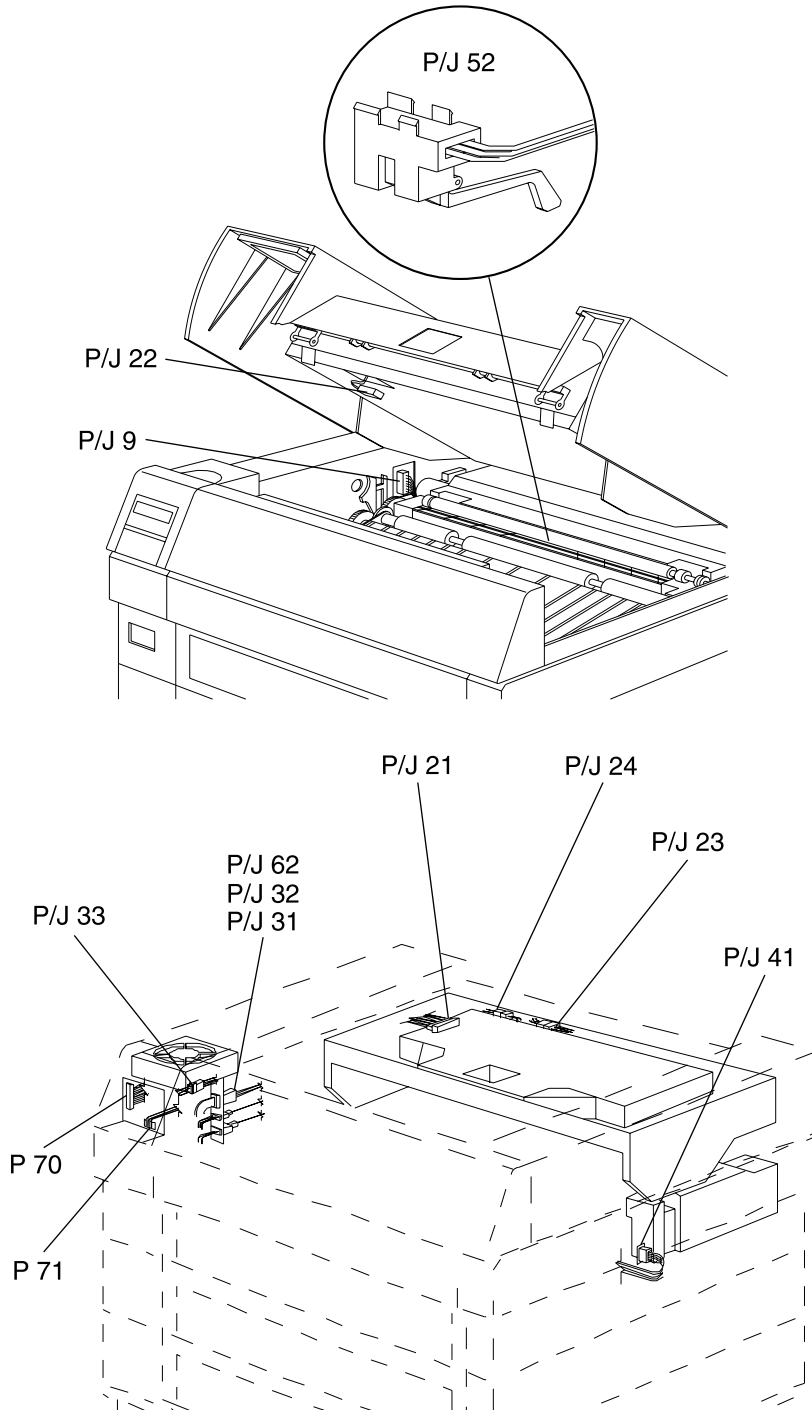

Pagemarq Printers

Before You Call For Help... Authorized Service Providers:	
Before calling for technical assistance with a problem, please perform the following procedures:	
❶	Perform the standard troubleshooting procedures given in the appropriate Compaq Maintenance and Service Guide.
❷	Have the following Compaq product information available: <ul style="list-style-type: none"><input checked="" type="checkbox"/> Serial Number<input checked="" type="checkbox"/> Model Number<input checked="" type="checkbox"/> Hardware Report<input checked="" type="checkbox"/> Error Log Report<input checked="" type="checkbox"/> Network Log Report (if applicable)<input checked="" type="checkbox"/> FAX Log Report (If FAX option is installed)<input checked="" type="checkbox"/> AppleTalk Log Report (If applicable)<input checked="" type="checkbox"/> Host Information<input checked="" type="checkbox"/> Software Applications and Selected Drivers